



# INDUSTRIAL UNITS FOR LEASE

UNIT 101 & 102  
8750 JIM BAILEY CRESCENT, KELOWNA, BC

STEVE LAURSEN  
PERSONAL REAL ESTATE CORPORATION

250.808.8101

JOEY STENSLAND  
SALES ASSOCIATE

250.470.7234

ROYAL LEPAGE KELOWNA

COMMERCIAL

[www.rlkcommercial.com](http://www.rlkcommercial.com)



## THE OPPORTUNITY

To lease Units 101 and 102 located within the Jim Bailey Industrial Centre. The development offers an exceptional opportunity to lease functional space within the Kelowna North Industrial area.

Units may be leased individually or combined, with each unit offering 1,800 SF on the main level, and 525 SF on the mezzanine. Each individual unit offers a total floor area of 2,325 SF, and collectively offer a total leasable floor area of 4,650 SF. Both units feature 26'6" clear ceiling heights, exclusive 14'x12' grade load overhead doors, 200 AMP 3-phase power, and reserved parking on-site.

## PROPERTY DETAILS



### MUNICIPAL ADDRESS

Unit 101 & 102  
8750 Jim Bailey Crescent,  
Kelowna, BC



### YEAR BUILT

2022



### LEASEABLE AREA (PER UNIT)

Main: 1,800 SF  
Mezzanine: 525 SF  
Total: 2,325 SF



### ZONING

I3 Heavy Industrial



### LEASE RATE

\$15.00 / SF



### NNN

\$4.00 / SF



### TERM

Unit 101: 2 Years  
Unit 102: 5-10 Years



### POSSESSION

Immediate



# FEATURES

CEILING HEIGHT	Main Warehouse: 26'6 Clear Under Mezz: 15'6 Clear
POWER	200 AMP 3-phase 120/208V
LOADING	One exclusive grade overhead door per unit 14' (H) x 12' (W)
LOAD CAPACITY	300 lb/sf on main floor
PARKING	2 Reserved stalls and additional shared visitor stalls



FRONT  
ENTRANCE

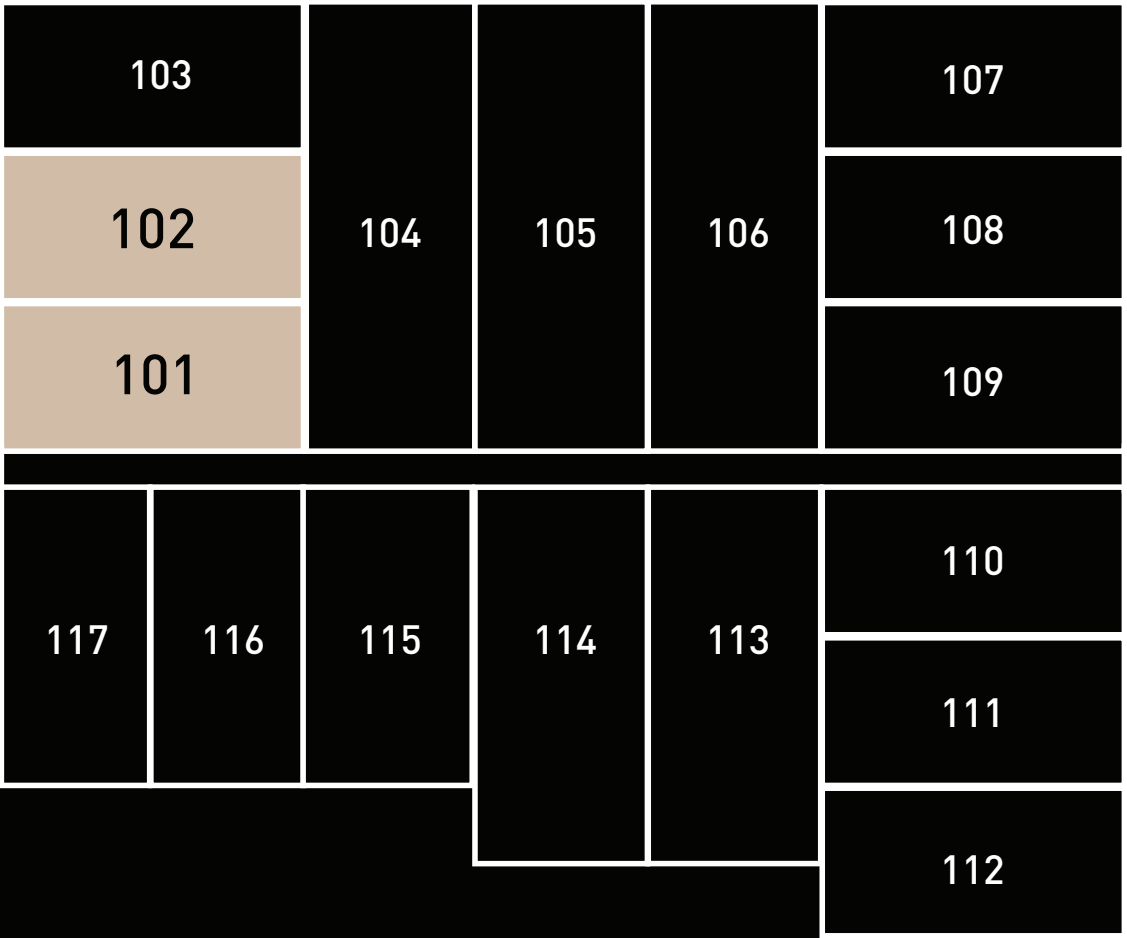











# LOCATION OVERVIEW

The Kelowna North Industrial Park, previously known for the Hiram Walker distillery and manufacturing area, is one of the fastest-growing industrial parks in the Okanagan. With easy access to Highway 97, this area provides local and national business operators an opportunity to service the Central and North Okanagan markets with ease.

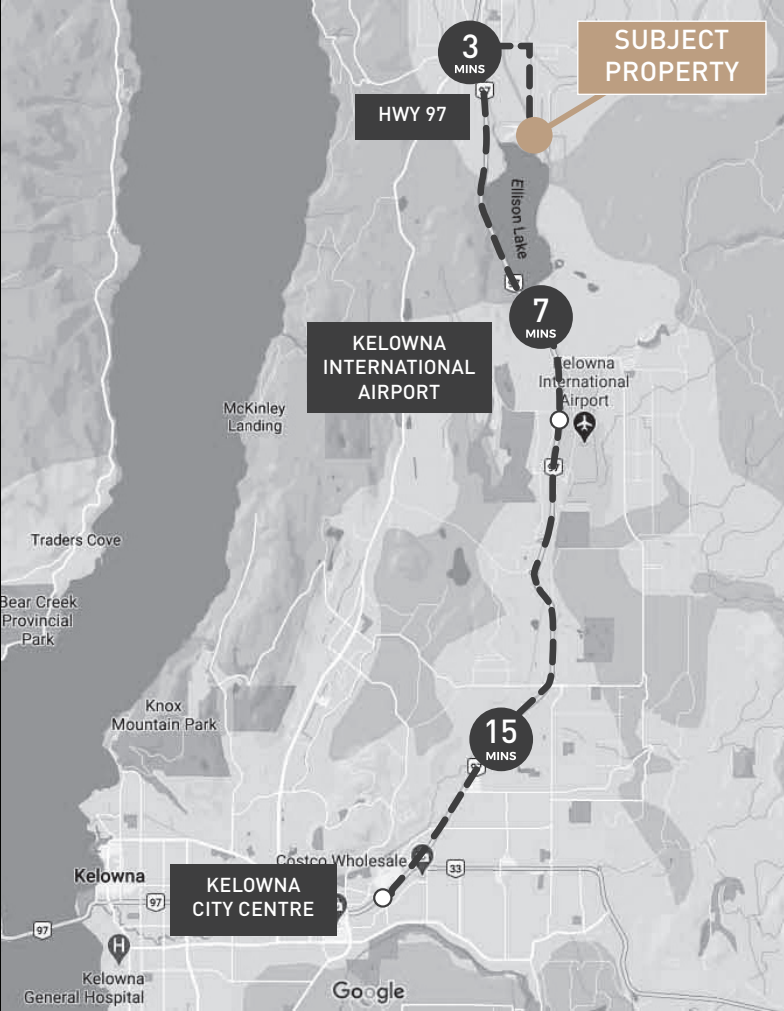
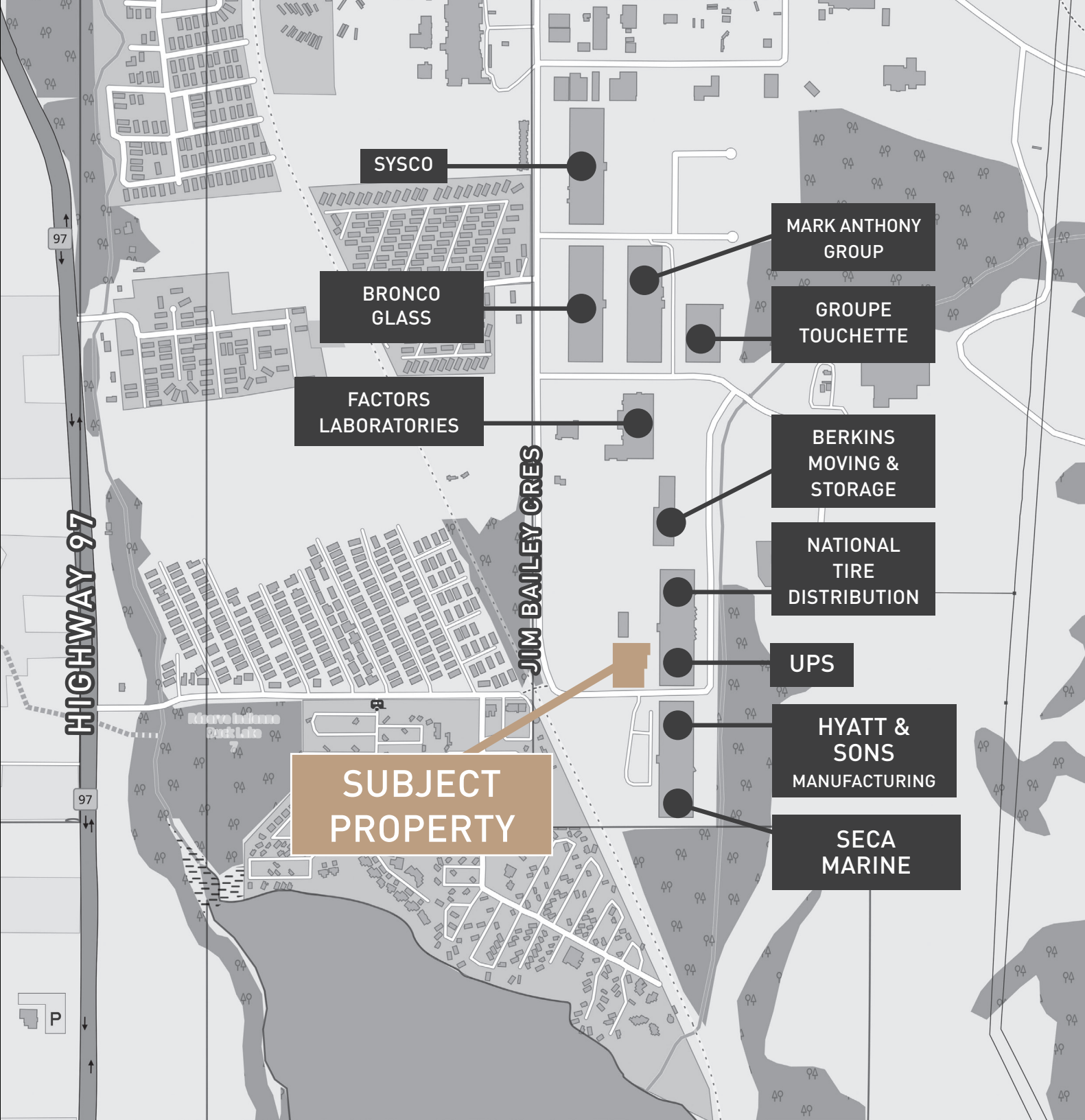

# CONTACT

STEVE LAURSEN

PERSONAL REAL ESTATE CORPORATION

250.808.8101

stevelaursen@rlkcommercial.com

JOEY STENSLAND

SALES ASSOCIATE

250.470.7234

joeystensland@rlkcommercial.com

ROYAL LEPAGE KELOWNA

# COMMERCIAL

www.rlkcommercial.com

This disclaimer shall apply to Steve Laursen Personal Real Estate Corporation (PREC\*), RLK Commercial, Royal Lepage Kelowna Real Estate Brokerage, and to all other divisions of the Corporation; to include all employees and independent contractors.

The information set out herein, including, without limitation, any projections, images, opinions, assumptions and estimates obtained from third parties (the "Information") has not been verified by Steve Laursen PREC\*, RLK Commercial, and Royal Lepage Kelowna does not represent, warrant or guarantee the accuracy, correctness and completeness of the Information.

Steve Laursen PREC\* does not accept or assume any responsibility or liability, direct or consequential, for the Information or the recipient's reliance upon the Information.

The recipient of the Information should take such steps as the recipient may deem necessary to verify the Information prior to placing any reliance upon the Information. The Information may change and any property described in the Information may be withdrawn from the market at any time without notice or obligation to the recipient from Steve Laursen PREC\*.

Steve Laursen PREC\* and the Royal Lepage Kelowna logo are the service marks of Steve Laursen PREC\* and Royal Lepage Kelowna.

Limited and/or its affiliated or related companies in other countries. All other marks displayed on this document are the property of their respective owners.

All Rights Reserved.